

LED TABLE LAMP User Manual

Product Introduction

Please read carefully before using and keep it properly

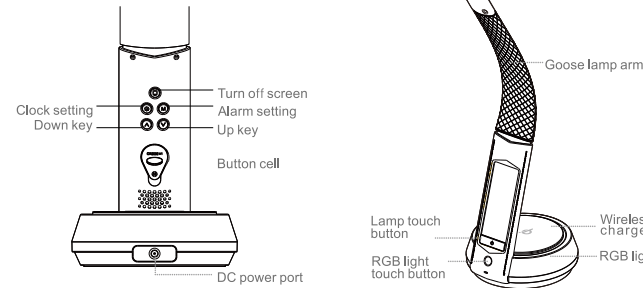

Instruction

1.power connection

Insert the matched adapter head into the socket behind the lamp.
Plug in the power adapter, the display automatically turns on, the buzzer beeps twice.

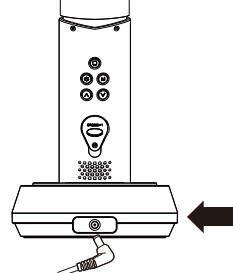

Notice:

- Please use the original power supply, do not use the cable extension or splitter, otherwise the product may not work correctly.
- Do not use an adapter which doesn't match with output 12V.
- If the lights flicker or are noisy, please check the power supply immediately.
- Do not connect the adapter metal point with other metals, or permanent damage to your product may occur.
- The original adapter is for this product only, and do not support for other use.

2.Display Brightness

LED light operation:

Short press the button to adjust the brightness level from low, medium, high to close cyclically.
Long press the button to switch the light mode from cold light, warm light to natural light cyclically.

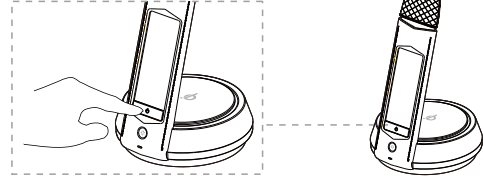

RGB light Operation:

Press to enter RGB light change automatically mode, and press again to stop change, long press will close the RGB light.

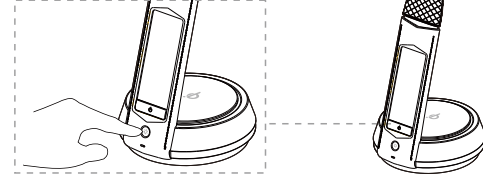

3.Time Setting

- In clock mode, press "S" to enter the setting time mode. Press "S" again to move to the next by the sequence: hour-minute-year-month-day.
- Press "A"/"V" to increase or decrease the value.
- No further operation after 1 minute or press "M" will exit the setting.
- In clock mode, press "A" can switch between 12 Hour and 24 Hour format. Press "V" can switch "C" and "F".

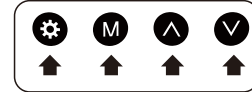

4.Alarm and Snooze Setting

- Press "M" in clock mode to enter the alarm setting.
- Press "S" to enter alarm setting, with the sequence of hour, minute, snooze, music choosing, then press "M" to quit.
- Press "A" to increase the time, and press "V" to decrease.
- In alarm mode, press either "A" or "V" key to turn on/off the alarm and snooze function. Press it again to start next function, with the sequence of turning on alarm clock, turning off alarm clock, and turning off snooze function.
- When rings, it will ring for 1 minute if no operation. If the snooze function is turned on, it automatically works, and press "S" or any key to stop it.

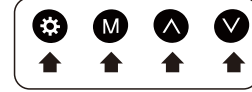

Wireless charging function
Put the equipment with Qi technical standard on the middle of to start charging.

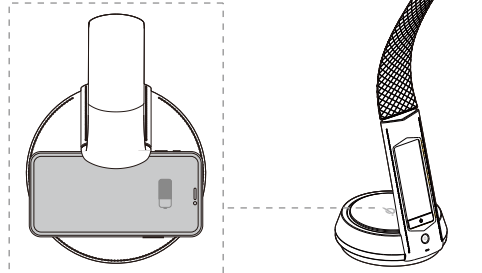

Notice: the light indicator is red when charging, and turn green when fully charged, if the red light is flashing, it means charging failure.

6.Illumination angle adjustment

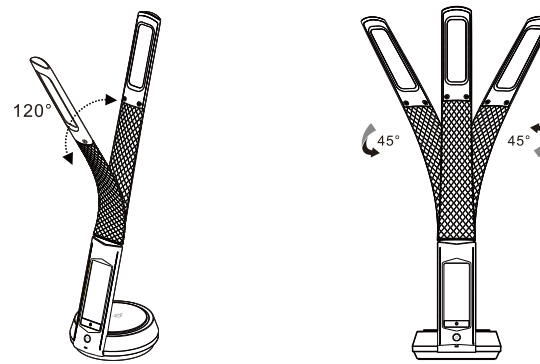

Package List



Note: Product images and description only for reference purpose. Due to product upgrading, physical picture may be associated with some small differences in kind, please see the subject product.

Specification

Model: B22D

Working temperature: -20-50°C

Rated power: 18W

Color temperature range: 3000K±280K,
4200K±400K, 5500K±500K

Product name : Table lamp with wireless charging
Rated Voltage : 12V/1.5A
Wireless charger power: 5W
Lamp size: 137. 7*136. 7*544. 8mm

Cautions

- Please wipe it by soft cotton fabric for surface cleaning, and do not use any corrosive solvents.
- The light source is irreplaceable. Please stop using when actually wear out
- If a failover occurs, please do not disassemble by yourself to avoid any damage on the product. You can contact the manufacture for maintenance.

Harmful matter content

Material	Hazardous substance					
	铅 (Pb)	汞 (Hg)	镉 (Cd)	六价铬 (Cr(VI))	多溴联苯 (PBB)	多溴二苯醚 (PBDE)
Metal	X	○	○	○	○	○
Plastic	○	○	○	○	○	○
Wire	○	○	○	○	○	○
PCBA board	○	○	○	○	○	○

The form is based on standard of SJ/T 11364:
○ : The hazardous substance is under the limit of the standard of GB/T 26572 in all homogeneous material of the component.
X : The hazardous substance is in excess of the standard of GB/T 26572 in at least one homogeneous material of the component



Product Warranty regulation

The warranty services of this product is strictly in accordance with consumer protection law of the UK.
If there is a performance fault listed in the "product performance fault table" after checking by after-sale service center, the service content is as follows:

- Within 30 days after receiving the product, it is free to enjoy the refund and exchange service.
- Within 60 days after receiving the product, it is free to enjoy replacement or maintenance service.
- Within 12 months after receiving the product, it is free to enjoy maintenance service.

Non-warranty regulation

- Unauthorized maintenance, misuse, collision, neglect, abuse, fluid intake, accident, altered or tear up labels/anti-fake label;
- Exceed the warranty validity date;
- Damage caused by force majeure;
- Troubles are not on the range of "product performance fault table"
- The human caused performance failure but listed in the product performance fault table, including use of dimmer/non-rated voltage/non-specified environment.

Product performance fault table

Model	Performance failure
B22D	1. The light doesn't work
	2. Lamp flickering
	3. Unable to turn on the light
	4. Slow wireless charging
	5. Shell is damaged due to structural or material factors

1. You're advised to keep the packing boxes for at least 30 days after receiving, since the packing boxes are used to ensure the safety of transportation;

Warranty card

Customer name ----- (Mr/Ms) Tel -----
Address serial ----- Number -----
Model Purchasing ----- Date -----
Purchasing store -----
Store address -----
Invoice number -----

Company Seal